



BARBICAN
T H E A T R E
P l y m o u t h

Castle Street / Plymouth / Devon / PL1 2NJ / Tel: 01752 267131 / Fax: 01752 222209

TECHNICAL INFORMATION FOR VISITING COMPANIES



BARBICAN
T H E A T R E
P l y m o u t h

Castle Street / Plymouth / Devon / PL1 2NJ / Tel: 01752 267131 / Fax: 01752 222209

PLEASE FILL IN THE FOLLOWING SHEETS AND RETURN NO LATER THAN THREE WEEKS BEFORE YOUR PERFORMANCE DATE

COMPANY

PRODUCTION

TECHNICAL MANAGER Tel.....
Fax.....
Email.....

Where will you be the week before your visit to The Barbican Theatre?
.....

Performance Dates At Barbican Theatre

Get in date & time

Get out date & duration

Show running time

Interval ? YES / NO

Do you require performance / dance floor laid over the dark wood sprung floor ? YES / NO Colour : BLACK / GREY

Do you require the front of the stage removed to reveal the pit for your use? (It is not possible to reveal the pit at short notice) YES / NO

Please describe **ANY** intended use of **NAKED FLAME**, petrol engines, flammable gases, strobes, lasers, pyrotechnics, theatrical smoke machines, onstage smoking by performers or any other effect likely to require approval by us and full specific risk assessments will be required.



BARBICAN
T H E A T R E
P l y m o u t h

Castle Street / Plymouth / Devon / PL1 2NJ / Tel: 01752 267131 / Fax: 01752 222209

Technical Information Auditorium

Access : The theatre building, auditorium, backstage areas and stage have good disabled and wheelchair access. The lighting control box and upper dressing room have difficult access.

Loading and unloading access for the Auditorium is via the rear of the building on Lambhay Street. There are a few steps outside and access is through the raked auditorium. (no lift is available to stage level)

Please Note : There is no parking available at this venue
Nearest recommended long stay car park is Elphineshtone Car park. It is located at the T- Junction of Lambhay hill and Madeira Rd.

This car park is 24hrs no height restrictions and accepts card payments £9 per day.

Auditorium

Seating : Standard - 110 fixed seats in a raked auditorium
Other - 145 seats with stepped pit open as seating area
Both end – on

Stage : A semi sprung wooden floor, with black / grey performance / dance floor available.
Stage front lifts out to reveal stepped pit beneath (see plans)
Open stage with flexible black drape surround, legs and cyclorama (see plans)

Dimensions : 10.20m width (wall to wall)
8.90m depth (7.15m depth with pit open)

5.50m height to LX Grid
7.90m to highest point of ceiling

Ceiling : The ceiling is beamed and vaulted above the lighting bar line

Dressing Rooms : 2 dressing rooms, and 1 x shower (shower has no disabled access)



BARBICAN
T H E A T R E
P l y m o u t h

Castle Street / Plymouth / Devon / PL1 2NJ / Tel: 01752 267131 / Fax: 01752 222209

Main Auditorium Specification

Lighting

Distribution : 96 circuits (15 amp)
Dimming : 54 ways DMX (Anytronics) in 3 phases
LX Desk: ETC Element 60
Riggers:- ETC iRFR iPad

Patching Notice: Dimmer Pack loads must not exceed 7.2kw per pack (we have 9 x dimmer packs with 6 x 10a ways on each). This is our maximum capacity on power distribution as each is supplied with a 32a RCBO breaker.

Projection

Projector : Panasonic PT-EW730Z 7500 lumens WXGA 16:10
Inputs via – VGA / HDMI
VGA/HDMI run to tech box

1x Screen : White Cyclorama at rear of stage – see plans

Sound

Speakers : 2 x ElectroVoice ETX10P
(overhead FOH Fixed position for rake seating)

2 x ElectroVoice ETX15SP (onstage Subs loose)
2 x ElectroVoice ZXA1 (fill speakers)

Monitors : 2 x ElectroVoice ETX10P active speakers (loose)
2 x Electrovoice ZXA1 active speakers (loose)

Sound Desk : Behringer X32
32 Mic/Line 48 Channel Digital Mixing Desk with 16 Aux Outs, 6 Matrix Outs and LCR/LR+Mono Main Outputs

Multicores : 2x Behringer S16 Digital snakes one SL and one SR

Playback : Twin CD, Mini Jack connection/XLR

Comms : Box/USL/USR/DSL/Seats

Effects : 1 x Jem Compact Hazer pro



BARBICAN
T H E A T R E
P l y m o u t h

Castle Street / Plymouth / Devon / PL1 2NJ / Tel: 01752 267131 / Fax: 01752 222209

Technical Equipment

Lantern stock

<u>Fresnel's</u>	<u>Quantity</u>	<u>Barn doors</u>
CCT Starlette Fresnel (1000w)	8	8
Strand Harmony Fresnel (1000w)	4	2
Strand Cantata Fresnel (1000w)	2	2
Strand Patt 743 Fresnel (1000w)	4	4
Strand Polaris Quartz colour Fresnel (1000w)	2	2
Strand Prelude F (650w)	1	1
Strand Quartet F (650w)	1	1

<u>PC Fresnel's</u>	<u>Quantity</u>	<u>Barn doors</u>
Strand Cantata PC (1200w)	5	5
Strand Quartet PC (650w)	11	11
Strand Prelude PC (650w)	6	6

<u>Pars</u>	<u>Quantity</u>	<u>Lamps</u>
Par 64 (1000w)	12	All CP62 Some CP61 and CP60 Lamps available
Par 36 (pin spots) (30w)	20	
Par 16 (birdies) 240v (35w)	8	

<u>Profiles</u>	<u>Quantity</u>	<u>Notes</u>
ETC Source 4 Jr 25/50 (575w)	4	
Strand SL 25/50 (600w)	6	4x gobo holders (size B)
Quartet 22/40 (650w)	6	4x gobo holders (size M)
Prelude 16/30 (650w)	6	
CCT Silhouette 30 (1000w)	3	4 x gobo holders (size A)

<u>Floods</u>	<u>Quantity</u>	
Strand Coda 1 (500w)	9	



BARBICAN
T H E A T R E
P l y m o u t h

Castle Street / Plymouth / Devon / PL1 2NJ / Tel: 01752 267131 / Fax: 01752 222209

LED	Quantity	
Philips Selecon PL1 Fresnel Mk2 RGBW	4	4
Philips Selecon PL1 Cyc Mk2	4	
ADJ mega Tripar profile plus RGB UV	16	0

Specials	Quantity	
Backlight blue UV Cannon	1	
4ft Fluorescent UV fittings	2	

Power Distro

Item	Quantity	
15a extension various lengths		
15a Grelcos/ 1 to 2 splitters	10	
16a extension various lengths		
16a 3 way splitter	1	



BARBICAN
T H E A T R E
P l y m o u t h

Castle Street / Plymouth / Devon / PL1 2NJ / Tel: 01752 267131 / Fax: 01752 222209

Microphones

Wireless:

- 2 x EW335 G3 GB Band Cardioid Handheld Radio Mic sets
- 1 x EW312 G3 GB Band Omnidirectional Lapel Radio Mic set
- 1 x Freeport FP12 Omnidirectional Lapel Radio Mic set

4 x Sure SM58 Dynamic microphones

Small selection of Microphone Stands/ Music stands

Processing

Selection of portable DI boxes and XLR cable

Other Stock

- 8 x Floor tank traps Black
- 8 x 1.9m high scaffold tubes Black
- 24 x silver boom arms
- 6 x H Floor stands
- 6 x Mini wooden floor stands for birdies

Masking

Standard configuration of the auditorium would provide black serge wool masking surrounding the stage. (Black box)

The up stage curtains are sewn ruched and are on a pulley track (USR) masking the white cyclorama.

The masking on stage left and right can be configured to provide wing space up to 1.5m deep (this does compromise stage space). An entrance DS, MS and upstage on both sides can be configured.

6 x 1.5m black serge hanging legs can also be provided.

2x 10m borders are also available (these are sewn ruched)



BARBICAN
T H E A T R E
P l y m o u t h

Castle Street / Plymouth / Devon / PL1 2NJ / Tel: 01752 267131 / Fax: 01752 222209



View from stage towards audience





BARBICAN
T H E A T R E
P l y m o u t h

Castle Street | Plymouth | Devon | PL1 2NJ | Tel: 01752 267131 | Fax: 01752 222209

Access to tech box



Inside the tech box

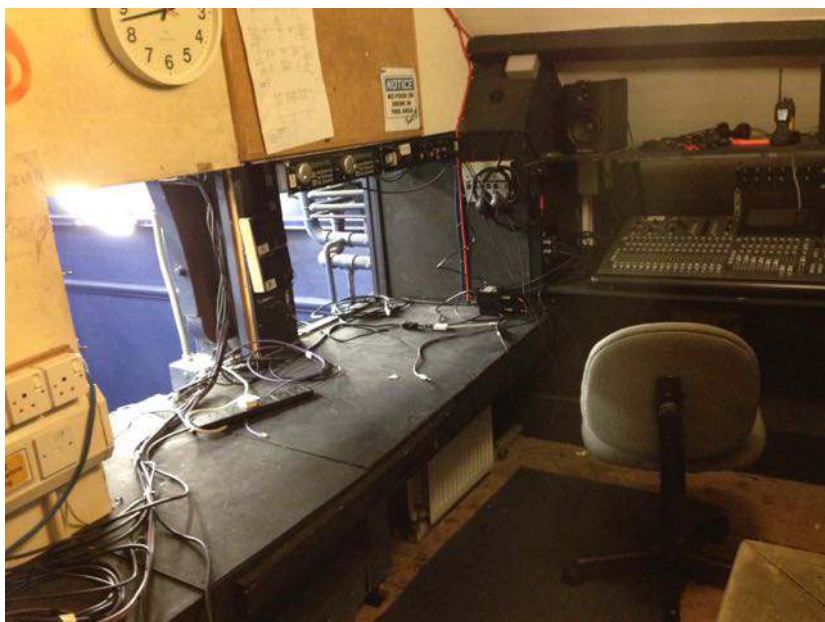



BARBICAN
T H E A T R E
P l y m o u t h

Castle Street | Plymouth | Devon | PL1 2NJ | Tel: 01752 267131 | Fax: 01752 222209

Sound mix position in the seating

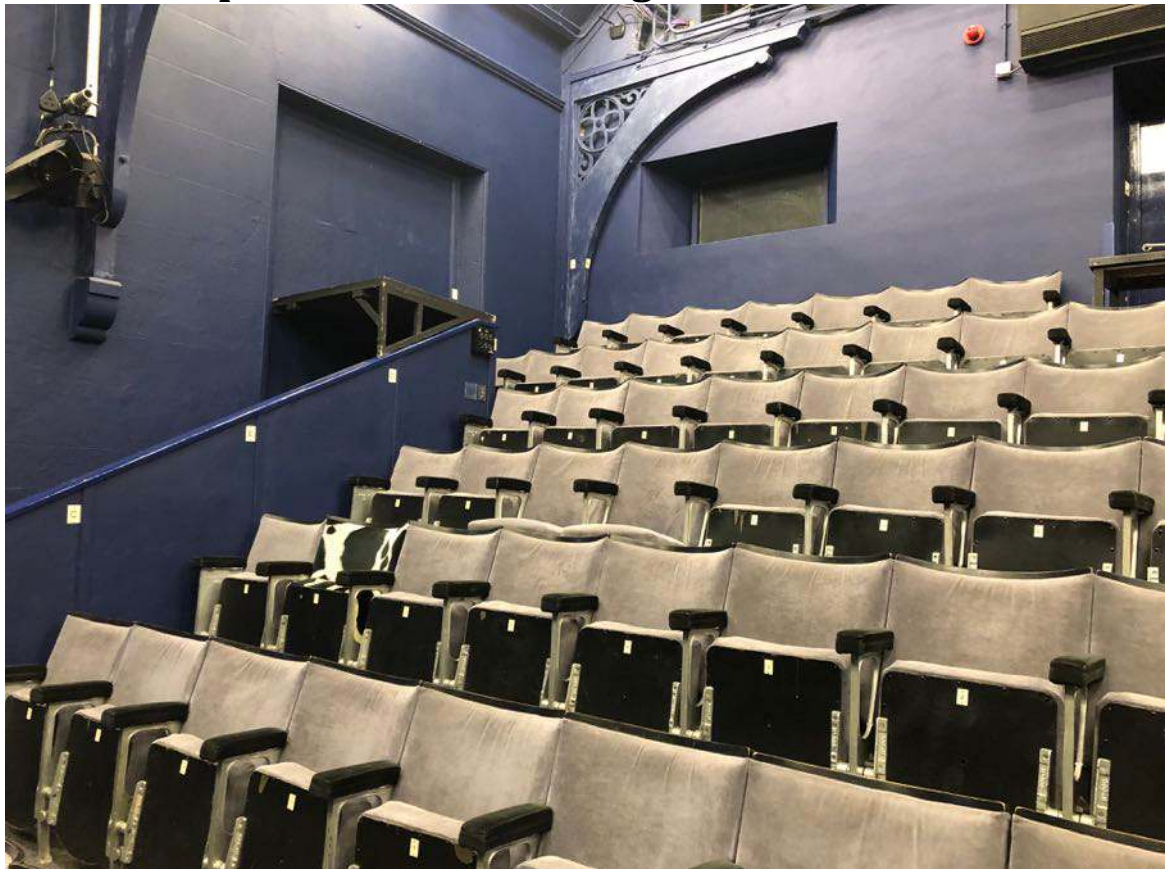



BARBICAN
T H E A T R E
P l y m o u t h

Castle Street / Plymouth / Devon / PL1 2NJ / Tel: 01752 267131 / Fax: 01752 222209

Auditorium Plans

Barbican Theatre Plymouth

Floor Plan – do not use as scaled

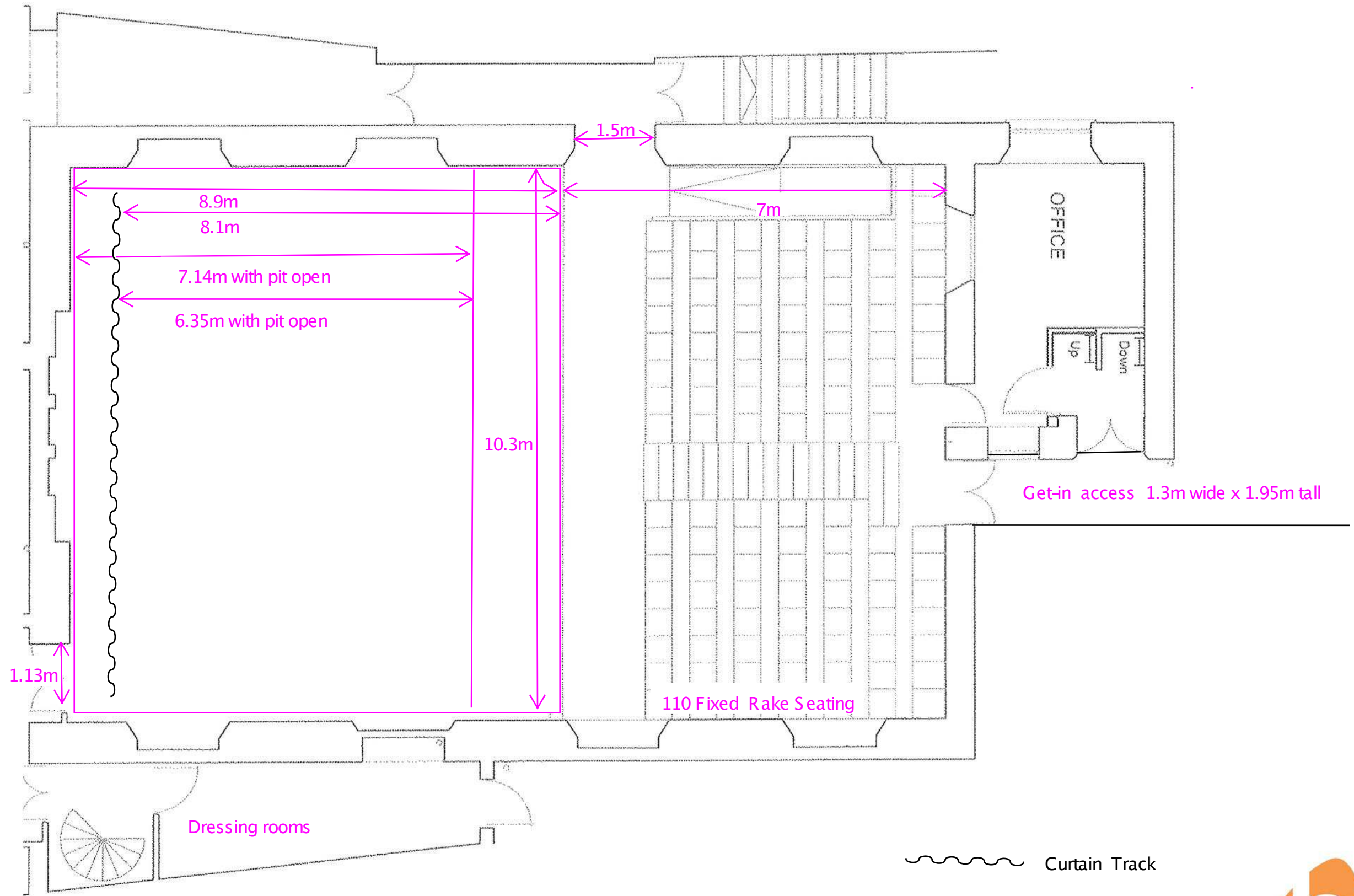

Barbican Theatre Plymouth

LX Layout - do not use as scaled

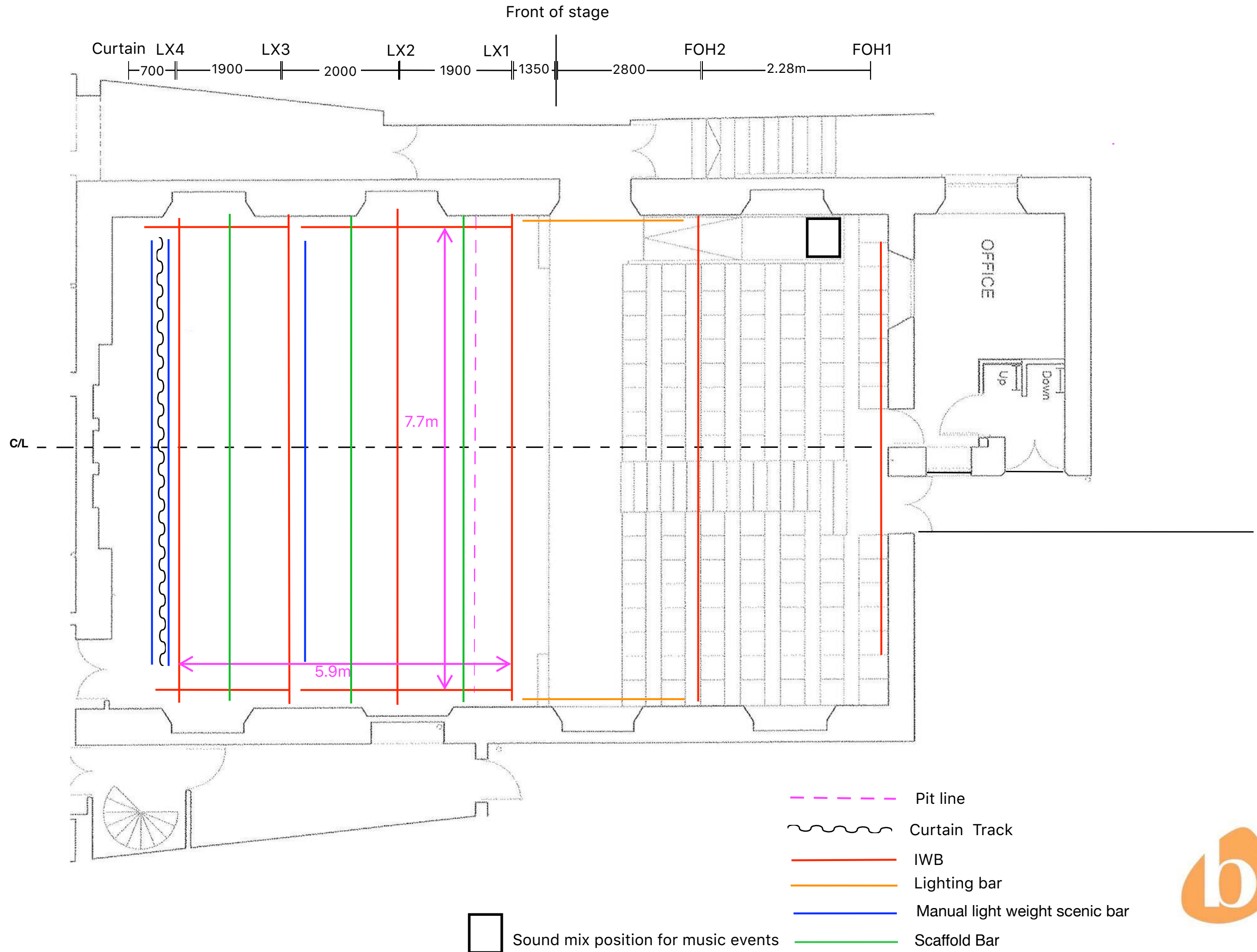



Lighting Plan: Barbican Theatre, Plymouth

Address : Castle St, Plymouth, PL1 2NJ

Scale :1:100

Contact :

Tel : 01752 267131

Fax : 01752 222209

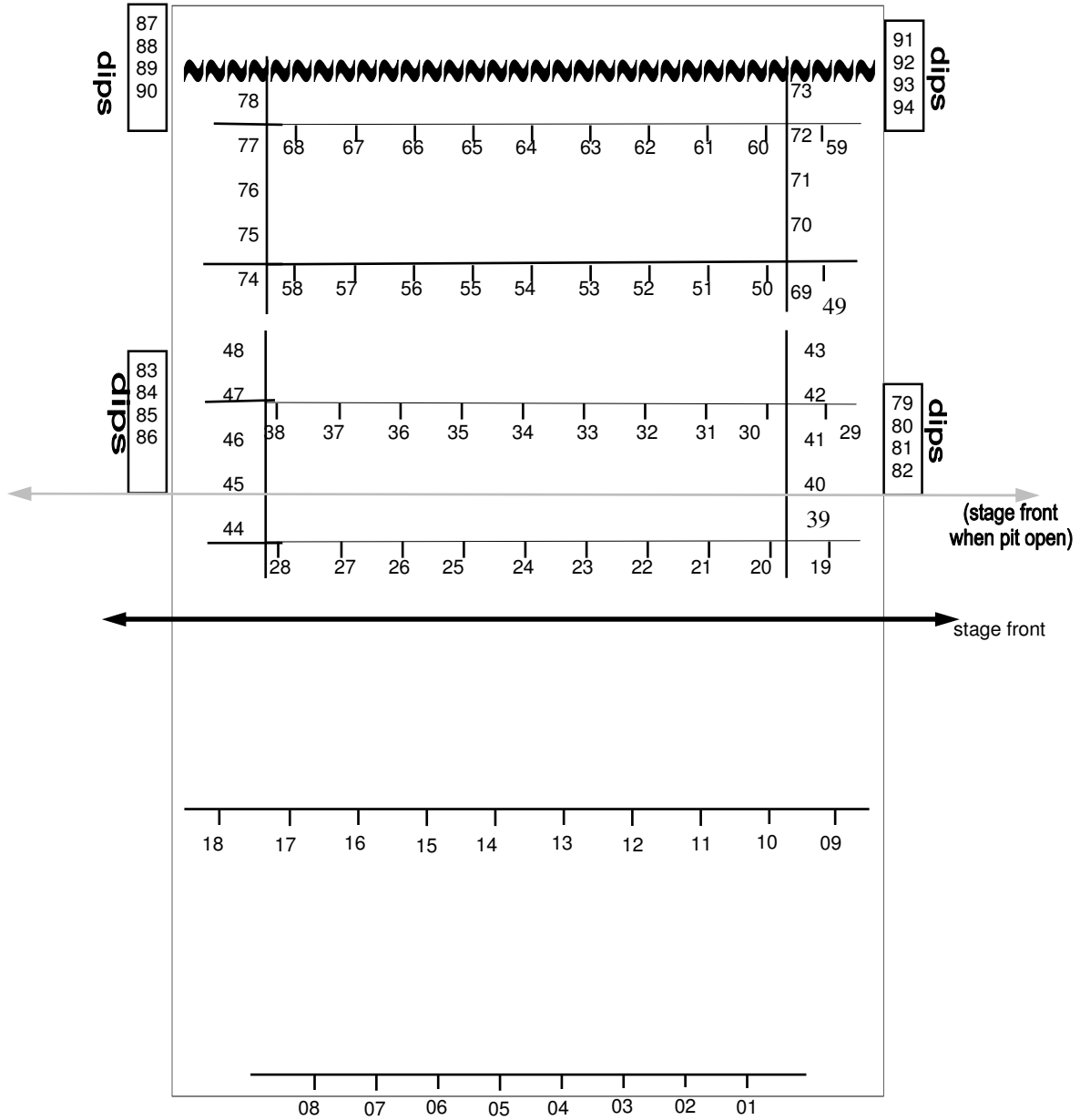

Notes:

Stage Rig Dimensions

Distance from US Lx bar to DS Lx Bar 68 - 28 5.9 meters

Distance from SR Lx Bar to SL Lx bar 44 - 39 7.7 meters